

# Zinnanti Smoke-Evac Derm Tip

14-3100

**Zinnanti Surgical Smoke-Evac Derm electrode, tubing kit & sterile sleeve are designed for use with the ConMed Hyfrecator® for Dermatology MOHS procedure.**

## **DIRECTIONS FOR USE / GENERAL OPERATION**

Zinnanti Smoke Evac derm electrode are provided sterile. Zinnanti Smoke Evac Hyfrecator tubing kit (14-4010HA) is provided non-sterile single use and does not require sterilization before use.

- 1) Place the soft plastic Y connector onto the distal end of the hand piece as shown (figure 1).
- 2) Place the sterile electrode into the hand piece through the open end of the tubing kit connector end first (figure 2).
- 3) Sterile sleeve is then placed over the electrode (figure 3).
- 4) Use tape on application ring to attach sleeve to sterile tip (figure 4).
- 5) Put applicator ring over tube set & cord to provide sterile barrier.

## **INDICATIONS FOR USE**

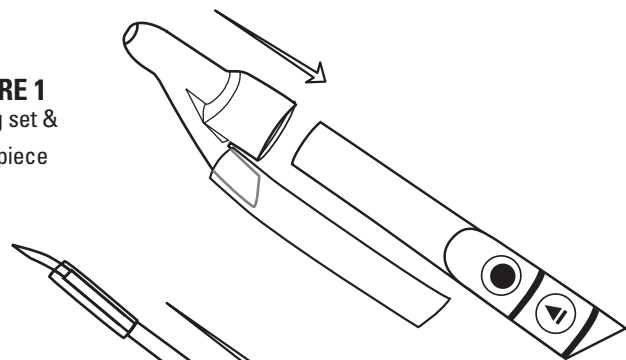
Consult Hyfrecator® instructions for use. Blades and tubing kit are designed for collection of smoke during Electrocautery of external procedures.



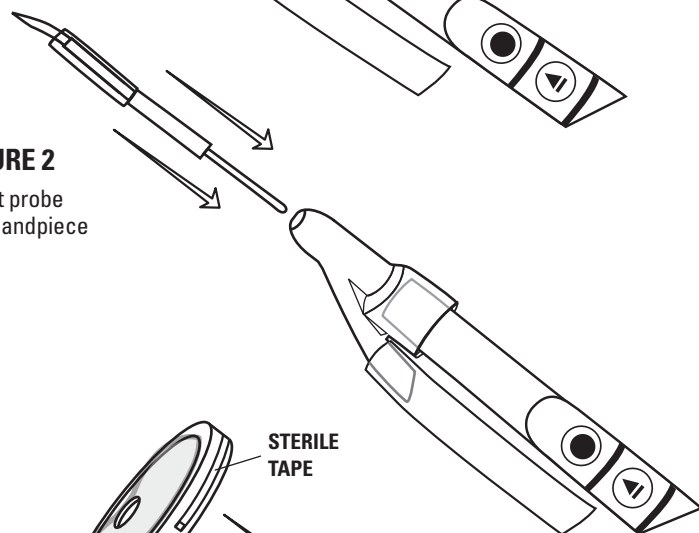
3540 Soquel Ave, Suite B,  
Santa Cruz, CA 95062

(800)459-1389, [www.zinnantisurgical.com](http://www.zinnantisurgical.com)

**FIGURE 1**  
Tubing set &  
hand-piece

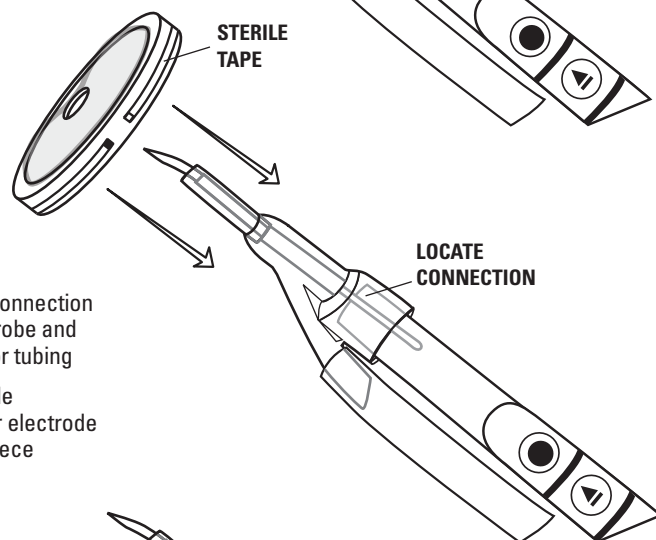


**FIGURE 2**  
Insert probe  
into handpiece



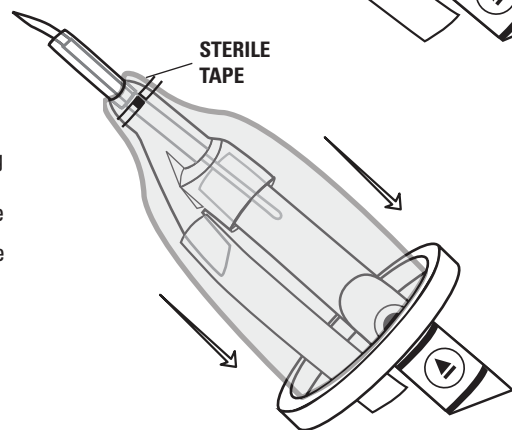
**FIGURE 3**

- a) locate connection between probe and Y-connector tubing
- b) slip sterile sleeve over electrode and handpiece



**FIGURE 4**

- a) gently pull sterile sleeve applicator ring downward to cover tubing and handpiece
- b) remove sterile tape from applicator ring, wrapping it tightly at top of sleeve- Wrap tape at bottom of handpiece if desired



**FIGURE 5**

Tubing connected to  
smoke evacuator

